

REMOVAL AND INSTALLATION

Instrument Panel

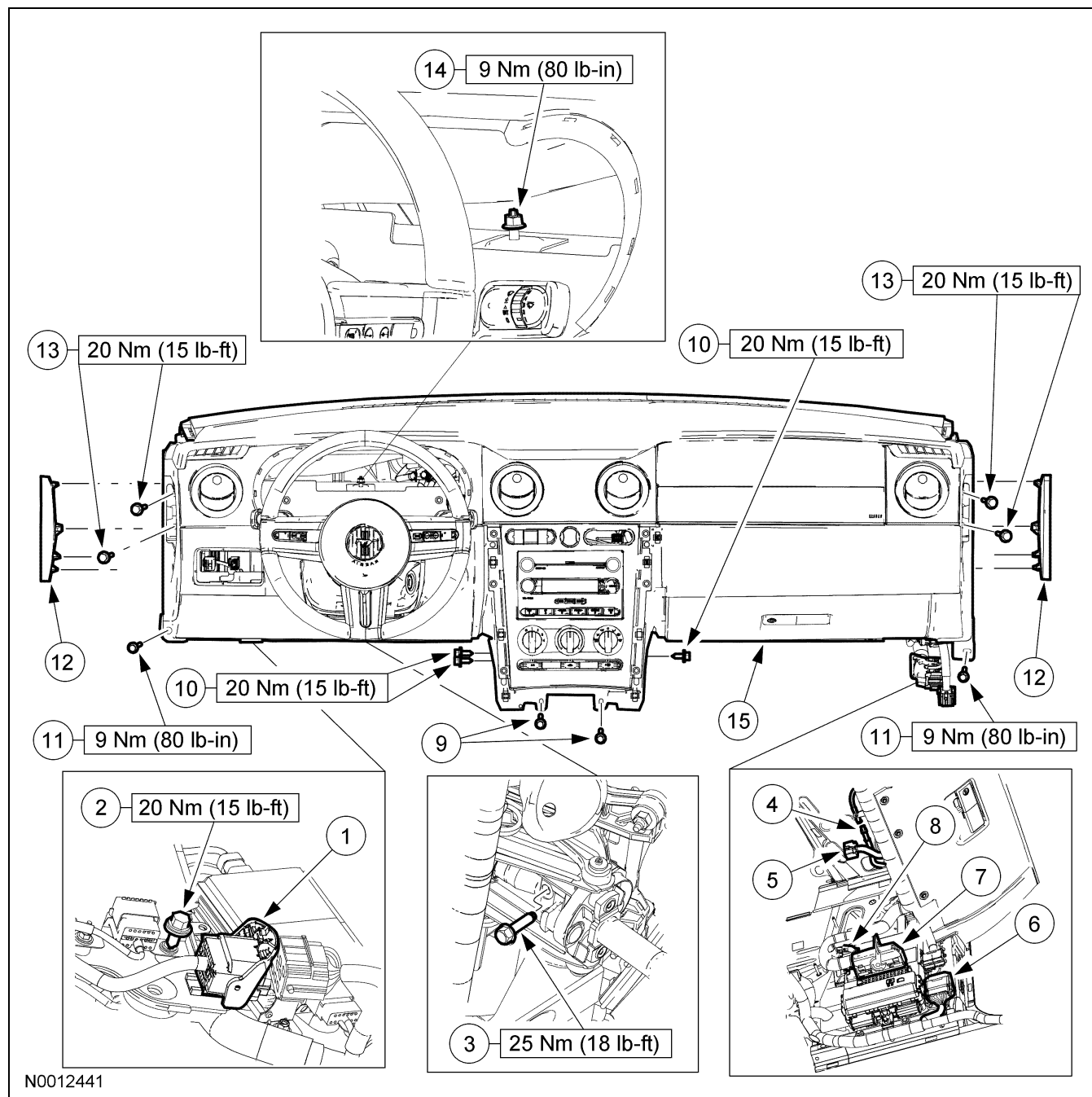

Item	Part Number	Description
1	—	Bulkhead electrical connector (part of 14401)
2	GD1E-55112	Instrument panel support bolt
3	W704980-S	Steering column shaft bolt
4	19A136	Antenna connector

(Continued)

Item	Part Number	Description
5	—	Defrost mode actuator electrical connector (part of 14401)
6	—	Bulkhead electrical connector (part of 14401)

(Continued)

REMOVAL AND INSTALLATION (Continued)

Item	Part Number	Description
7	—	Smart junction box (SJB) electrical connector (part of 14401)
8	—	SJB electrical connector (part of 14401)
9	06010	Instrument panel center support screws (2 required)
10	GD1E-55112	Instrument panel center support bolts (3 required)
11	18C298	Instrument panel lower support bolts (2 required)
12	6304481/ 6304480	Instrument panel end panels (2 required)
13	GD1E-55112	Instrument panel upper support bolts (4 required)
14	N811309-S437	Instrument panel cowl top bracket nut
15	04304	Instrument panel

Removal and Installation

 **CAUTION:** Electronic modules are sensitive to static electrical charges. If exposed to these charges, damage may result.

- Depower the supplemental restraint system (SRS). For additional information, refer to Section 501-20B.
- Remove the floor console. For additional information, refer to Floor Console in this section.
- Remove the 2 scuff plates.
- Remove the 2 A-pillar lower trim panels.
- NOTE:** On coupe, install the front locating hook, then snap the A-pillar trim panel in place working rearward.
Remove the 2 A-pillar trim panels.
- Remove the instrument cluster. For additional information, refer to Section 413-01.
-  **CAUTION:** Do not allow the steering column to rotate while the steering column shaft is disconnected or damage to the clockspring can result. If there is evidence that the steering column shaft has rotated, the clockspring must be removed and recentered. For additional information, refer to Section 501-20B.
Secure the steering wheel, remove and discard the bolt, and separate the steering column shaft from the steering column.
 - To install, tighten to 25 Nm (18 lb-ft).
- On the LH side disconnect the instrument panel bulkhead electrical connector and remove the instrument panel support bolt.
 - To install, tighten to 20 Nm (15 lb-ft).
- On the RH side disconnect antenna in-line connector and the 4 instrument panel harness electrical connectors.
- Remove the 2 instrument panel center support screws.
- Remove the 3 instrument panel center support bolts.
 - To install, tighten to 20 Nm (15 lb-ft).
- Through the instrument cluster opening, loosen the instrument panel cowl top bracket nut.
 - Tighten to 9 Nm (80 lb-in).
- Remove the 2 instrument panel lower support bolts.
 - To install, tighten to 9 Nm (80 lb-in).
- Remove the 2 instrument panel end panels.
- Remove the 4 instrument panel upper support bolts.
 - To install, tighten to 20 Nm (15 lb-ft).

REMOVAL AND INSTALLATION (Continued)

16. **NOTE:** Two technicians are necessary to carry out this step.
Remove the instrument panel.
17. To install, reverse the removal procedure.
-